



# Away from the Desk

A dynamic & extensive  
upholstery system



## Product Description

Away from the Desk (AftD) is a soft upholstery system designed to answer the rapidly changing needs of the workplace as we migrate away from personal desks with their fixed and tethered technology towards shared, collaborative spaces and furniture.

AftD answers the need for more diverse configurations for both personal work and teamwork. Multiple specification options – for individual use, or for two, four or six people – can be further configured with larger, more open and more inclusive collaborative working configurations at lounge, table or café height.

AftD's high back design provides refined acoustic and visual privacy, and offers an upright, ergonomically controlled seating position more reflective of a task seat posture. It also provides multiple specification options for large and small work surfaces, and can meet a wide variety of power, data and monitor requirements.

With the help of our clients, their designers and specifiers, AftD is helping to transform office environments and working practices. And, just as the 'Hoover' brand gave birth to the verb 'to Hoover' (though we wouldn't dare to go as far as comparing their stories!), AftD has become an industry archetype, used as a verb to describe being able to work increasingly away from the desk.







## Product Range

<p><b>AD-01</b> 800mm straight seat</p>  <p>H470 [H22] SH480 [SH19] W800 [W31] D510 [D20] SD500 [SD20]</p>	<p><b>AD-02</b> 800mm straight seat &amp; back</p>  <p>H820 [H32] SH480 [SH19] W800 [W31] D660 [D26] SD500 [SD20]</p>	<p><b>AD-03</b> 800mm straight seat, back &amp; screen</p>  <p>H1470 [H58] SH480 [SH19] W800 [W31] D710 [D28] SD500 [SD20]</p>	<p><b>AD-03 LC</b> 800mm straight seat, back &amp; left hand chamfered screen</p>  <p>H1470 [H58] SH480 [SH19] W800 [W31] D710 [D28] SD500 [SD20]</p>	<p><b>AD-03 RC</b> 800mm straight seat, back &amp; right hand chamfered screen</p>  <p>H1470 [H58] SH480 [SH19] W800 [W31] D710 [D28] SD500 [SD20]</p>	<p><b>AD-11</b> 1800mm straight seat</p>  <p>H470 [H22] SH480 [SH19] W800 [W31] D710 [D28] SD500 [SD20]</p>	<p><b>AD-12</b> 1800mm straight seat &amp; back</p>  <p>H470 [H22] SH480 [SH19] W1800 [W31] D600 [D24] SD500 [SD20]</p>
<p><b>AD-13</b> 1800mm straight seat, back &amp; screen</p>  <p>H1470 [H58] SH480 [SH19] W1800 [W31] D710 [D28] SD500 [SD20]</p>	<p><b>AD-13 LC</b> 1800mm straight seat, back &amp; left hand chamfered screen</p>  <p>H1470 [H58] SH480 [SH19] W1800 [W31] D710 [D28] SD500 [SD20]</p>	<p><b>AD-13 RC</b> 1800mm straight seat, back &amp; right hand chamfered screen</p>  <p>H1470 [H58] SH480 [SH19] W1800 [W31] D710 [D28] SD500 [SD20]</p>	<p><b>AD-21</b> 120° seat</p>  <p>H470 [H22] SH480 [SH19] W1985 [W78] D910 [D36] SD500 [SD20]</p>	<p><b>AD-22</b> 120° seat &amp; external back</p>  <p>H820 [H32] SH480 [SH19] W2130 [W84] D1060 [D42] SD500 [SD20]</p>	<p><b>AD-23</b> 120° seat, external back &amp; screen</p>  <p>H1470 [H58] SH480 [SH19] W2185 [W86] D1110 [D44] SD500 [SD20]</p>	<p><b>AD-23 LC</b> 120° seat, external back &amp; left hand chamfered screen</p>  <p>H1470 [H58] SH480 [SH19] W2160 [W85] D1110 [D44] SD500 [SD20]</p>
<p><b>AD-23 RC</b> 120° seat, external back &amp; left hand chamfered screen</p>  <p>H1470 [H58] SH480 [SH19] W2160 [W85] D1110 [D44] SD500 [SD20]</p>	<p><b>AD-23 DC</b> 120° seat, external back &amp; double chamfered screen</p>  <p>H1470 [H58] SH480 [SH19] W2130 [W84] D1110 [D44] SD500 [SD20]</p>	<p><b>AD-24</b> 120° seat &amp; internal back</p>  <p>H820 [H32] SH480 [SH19] W1985 [W78] D1045 [D41] SD500 [SD20]</p>	<p><b>AD-25</b> 120° seat, internal back &amp; screen</p>  <p>H1470 [H58] SH480 [SH19] W1985 [W78] D1090 [D43] SD500 [SD20]</p>	<p><b>AD-25 LC</b> 120° seat, internal back &amp; left hand chamfered screen</p>  <p>H1470 [H58] SH480 [SH19] W1985 [W78] D1090 [D43] SD500 [SD20]</p>	<p><b>AD-25 RC</b> 120° seat, internal back &amp; right hand chamfered screen</p>  <p>H1470 [H58] SH480 [SH19] W1985 [W78] D1090 [D43] SD500 [SD20]</p>	<p><b>AD-25 DC</b> 120° seat, internal back &amp; double chamfered screen</p>  <p>H1470 [H58] SH480 [SH19] W1985 [W78] D1090 [D43] SD500 [SD20]</p>
<p><b>AD-31</b> 120° tri seat</p>  <p>H470 [H19] SH480 [SH19] W1985 [W78] D1720 [D68] SD500 [SD20]</p>	<p><b>AD-32</b> 120° tri seat &amp; internal back</p>  <p>H820 [H32] SH480 [SH19] W1985 [W78] D1850 [D73] SD500 [SD20]</p>	<p><b>AD-33</b> 120° tri seat, internal back &amp; screen</p>  <p>H1470 [H58] SH480 [SH19] W1985 [W78] D1890 [D74] SD500 [SD20]</p>	<p><b>AD-33 LC</b> 120° tri seat, internal back &amp; left hand chamfered screen</p>  <p>H1470 [H58] SH480 [SH19] W1985 [W78] D1890 [D74] SD500 [SD20]</p>	<p><b>AD-33 RC</b> 120° tri seat, internal back &amp; right hand chamfered screen</p>  <p>H1470 [H58] SH480 [SH19] W1985 [W78] D1890 [D74] SD500 [SD20]</p>	<p><b>AD-33 DC</b> 120° tri seat, internal back &amp; double chamfered screen</p>  <p>H1470 [H58] SH480 [SH19] W1985 [W78] D1850 [D73] SD500 [SD20]</p>	<p><b>AD-41</b> 90° seat</p>  <p>H470 [H19] SH480 [SH19] W1295 [W51] D1295 [D51] SD500 [SD20]</p>
<p><b>AD-42</b> 90° seat &amp; back</p>  <p>H820 [H32] SH480 [SH19] W1445 [W57] D1445 [D57] SD500 [SD20]</p>	<p><b>AD-43</b> 90° seat, back &amp; screen</p>  <p>H1470 [H58] SH480 [SH19] W1495 [W59] D1495 [D59] SD500 [SD20]</p>	<p><b>AD-43 LC</b> 90° seat, back &amp; left hand chamfered screen</p>  <p>H1470 [H58] SH480 [SH19] W1495 [W59] D1495 [D59] SD500 [SD20]</p>	<p><b>AD-43 RC</b> 90° seat, back &amp; right hand chamfered screen</p>  <p>H1470 [H58] SH480 [SH19] W1495 [W59] D1495 [D59] SD500 [SD20]</p>	<p><b>AD-43 DC</b> 90° seat, back &amp; double chamfered screen</p>  <p>H1470 [H58] SH480 [SH19] W1495 [W59] D1495 [D59] SD500 [SD20]</p>	<p><b>AD-52</b> 90° curved seat &amp; back</p>  <p>H820 [H32] SH480 [SH19] W1835 [W72] D850 [D33] SD500 [SD20]</p>	<p><b>AD-53</b> 90° curved seat, back &amp; screen</p>  <p>H1470 [H58] SH480 [SH19] W1900 [W75] D900 [D35] SD500 [SD20]</p>

## Product Range

### AD-53 LC

90° curved seat, back & left hand chamfered screen

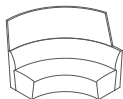

H1470 [H58] SH480 [SH19]  
W1865 [W73]  
D900 [D35] SD500 [SD20]

### AD-53 RC

90° curved seat, back & right hand chamfered screen

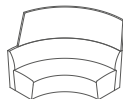

H1470 [H58] SH480 [SH19]  
W1865 [W73]  
D900 [D35] SD500 [SD20]

### AD-53 DC

90° curved seat, back & double chamfered screen

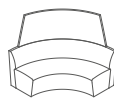

H1470 [H58] SH480 [SH19]  
W1835 [W72]  
D900 [D35] SD500 [SD20]

### AD-55

90° small curved seat & back

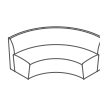

H820 [H32] SH480 [SH19]  
W1635 [W64]  
D805 [D32] SD500 [SD20]

### AD-56

90° small curved seat, back & screen

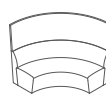

H1470 [H58] SH480 [SH19]  
W1710 [W67]  
D855 [D34] SD500 [SD20]

### AD-56 LC

90° small curved seat, back & left hand chamfered screen

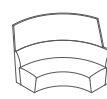

H1470 [H58] SH480 [SH19]  
W1670 [W66]  
D855 [D34] SD500 [SD20]

### AD-56 RC

90° small curved seat, back & right hand chamfered screen

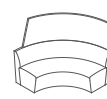

H1470 [H58] SH480 [SH19]  
W1670 [W66]  
D855 [D34] SD500 [SD20]

### AD-56 DC

90° small curved seat, back & double chamfered screen

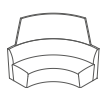

H1470 [H58] SH480 [SH19]  
W1635 [W64]  
D855 [D34] SD500 [SD20]

### AD-57 LH

Small left hand spur

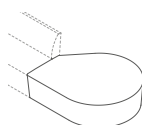

H470 [H19]  
W1340 [W53]  
D1600 [D63]

### AD-57 RH

Small right hand spur

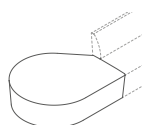

H470 [H19]  
W1340 [W53]  
D1600 [D63]

### AD-58 LH

Large left hand spur

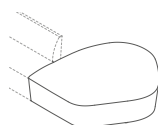

H470 [H19]  
W1430 [W56]  
D1600 [D63]

### AD-58 RH

Large right hand spur

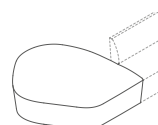

H470 [H19]  
W1430 [W56]  
D1600 [D63]

### AD-59 LH

Left hand spur arm

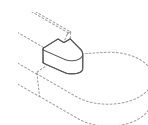

H220 [H9]  
W540 [W21]  
D440 [D17]

### AD-59 RH

Right hand spur arm

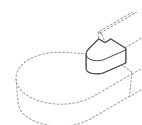

H220 [H9]  
W540 [W21]  
D440 [D17]

### AD-61 LA

Upholstered left hand arm

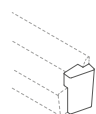

H700 [H28]  
W275 [W11]  
D460 [D18]

### AD-61 RA

Upholstered right hand arm

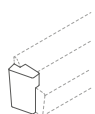

H700 [H28]  
W275 [W11]  
D460 [D18]

### AD-62 LC

Upholstered left hand arm with side table

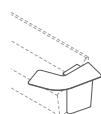

H725 [H29]  
W780 [W31]  
D1025 [D40]

### AD-62 RC

Upholstered right hand arm with side table

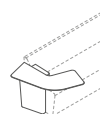

H725 [H29]  
W780 [W31]  
D1025 [D40]

### AD-63 LP

LH presentation top with upholstered base

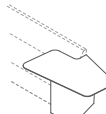

H725 [H29]  
W900 [W35]  
D1335 [D53]

### AD-63 RP

RH presentation top with upholstered base

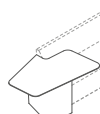

H725 [H29]  
W900 [W35]  
D1335 [D53]

### AD-64 SRO

Large upholstered, tapered base with small round top

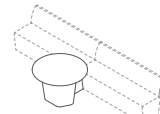

H730 [H29]  
W1100 [W43]  
D1100 [D43]

### AD-64 MRO

Large upholstered, tapered base with medium round top

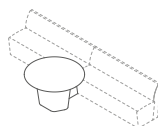

H730 [H29]  
W1200 [W47]  
D1200 [D47]

### AD-64 LRO

Large upholstered, tapered base with large round top

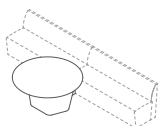

H730 [H29]  
W1400 [W55]  
D1400 [D55]

### AD-64 SW

Large upholstered, tapered base with small winged top

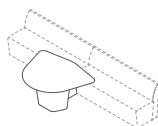

H730 [H29]  
W1450 [W57]  
D1200 [D47]

### AD-64 LW

Large upholstered, tapered base with large winged top

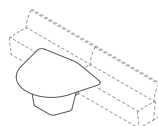

H730 [H29]  
W1655 [W65]  
D1400 [D55]

### AD-64 120

Large upholstered, tapered base with 120° top

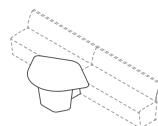

H730 [H29]  
W1465 [W58]  
D1135 [D45]

### AD-64 HE

Extra large upholstered, tapered base with hex top

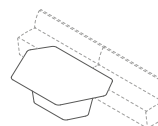

H730 [H29]  
W2170 [W85]  
D1400 [D55]

### AD-67 RE

Integrated banquette base with rectangular top

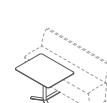

H730 [H29]  
W950 [W37]  
D750 [D30]

### AD-67 SQ

Integrated banquette base with square top

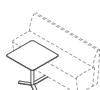

H730 [H29]  
W750 [W30]  
D750 [D30]

### AD-71

Upholstered square corner table with cam top

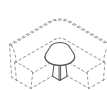

H730 [H29]  
W600 [W24]  
D790 [D31]

### AD-72

Upholstered oval base with rounded top

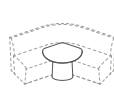

H730 [H29]  
W800 [W31]  
D700 [D28]

### AD-81 DS

Low media unit with D - shaped top table height - 730mm



H1455 [H57]  
W1300 [W51]  
D1350 [D53]

### AD-81 OV

Low media unit with group top [oval] table height - 730mm

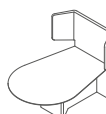

H1455 [H57]  
W1300 [W51]  
D1850 [D73]

### AD-81 GR

Low media unit with group top [rounded] table height - 730mm

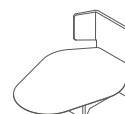

H1455 [H57]  
W1320 [W52]  
D1850 [D73]

### AD-81 GT

Low media unit with group top [tapered] table height - 730mm

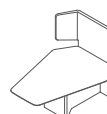

H1455 [H57]  
W1310 [W52]  
D1850 [D73]



## Product Range

### AD-81 HE120

Low media unit with hex top  
table height - 730mm

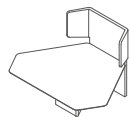

H1455 [H57]  
W2170 [W85]  
D1650 [D65]

### AD-81 HE90

Low media unit with hex top  
table height - 730mm

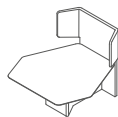

H1455 [H57]  
W1675 [W66]  
D1650 [D65]

### AD-82 DS

High media unit with D-shaped top  
table height - 1050mm



H1775 [H70]  
W1300 [W51]  
D1350 [D53]

### AD-82 OV

High media unit with group top (oval)  
table height - 1050mm



H1775 [H70]  
W1300 [W51]  
D1850 [D73]

### AD-85

Enclosed media den (seats 6-8 people)  
table height - 730mm

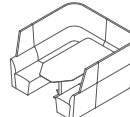

H1470 [H58] SH480 [SH19]  
W2350 [W93]  
D2295 [D90] SD500 [SD20]

### AD-85 A

Enclosed media den (seats 4-6 people)  
table height - 730mm

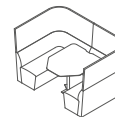

H1470 [H58] SH480 [SH19]  
W2350 [W93]  
D1495 [D59] SD500 [SD20]

### AD-85 B

Enclosed media den (seats 2 people)  
table height - 730mm

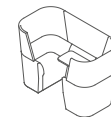

H1470 [H58] SH480 [SH19]  
W2130 [W84]  
D1140 [D45] SD500 [SD20]

### AD-85 C

Enclosed media booth (seats 4-6 people)  
table height - 730mm

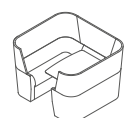

H1470 [H58] SH480 [SH19]  
W2130 [W84]  
D1945 [D77] SD500 [SD20]

### AD-85 D

Enclosed media booth (seats 6-8 people)  
table height - 730mm



H1470 [H58] SH480 [SH19]  
W2130 [W84]  
D2440 [D96] SD500 [SD20]

### AD-86 LH

Left handed work station with table  
table height - 730mm

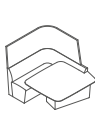

H1470 [H58] SH480 [SH19]  
W1580 [W62]  
D1955 [D77] SD500 [SD20]

### AD-86 RH

Right handed work station with table  
table height - 730mm

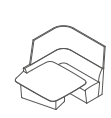

H1470 [H58] SH480 [SH19]  
W1580 [W62]  
D1955 [D77] SD500 [SD20]

### AD-87 C

Curved seating configuration with table  
table height - 730mm

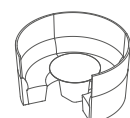

H1470 [H58] SH480 [SH19]  
W2700 [W106]  
D2300 [D91] SD500 [SD20]

### AD-87 S

Square seating configuration

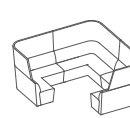

H1470 [H58] SH480 [SH19]  
W2990 [W114]  
D2990 [D114] SD500 [SD20]

### AD-88 C1

Seating Configuration 1-90° units

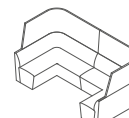

H1470 [H58] SH480 [SH19]  
W2990 [W118]  
D1495 [D59] SD500 [SD20]

### AD-88 C2

Seating Configuration 2-120° units

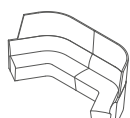

H1470 [H58] SH480 [SH19]  
W3700 [W146]  
D1450 [D57] SD500 [SD20]

### AD-88 C3

Seating Configuration 3-90° units & 120° units

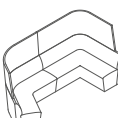

H1470 [H58] SH480 [SH19]  
W3300 [W130]  
D1495 [D59] SD500 [SD20]

### AD-88 C4

Seating Configuration 4-90° units & 120° units

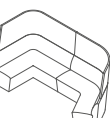

H1470 [H58] SH480 [SH19]  
W3300 [W130]  
D1495 [D59] SD500 [SD20]

### AD-91 SRO

Huddle buddle group working table 1200 diameter top



H730 [H29]  
W1200 [W47]  
D1200 [D47]

### AD-91 LRO

Huddle buddle group working table 1400 diameter top

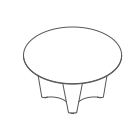

H730 [H29]  
W1400 [W55]  
D1400 [D55]

### AD-92

600mm diameter working table



H500 [H20]  
W600 [W24]  
D600 [D24]

### AD-101

Single seat unit

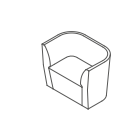

H820 [H32] SH480 [SH19]  
W1035 [W41]  
D660 [D26] SD500 [SD20]

### AD-102

Single seat unit & screen

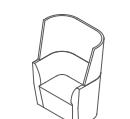

H1470 [H58] SH480 [SH19]  
W1140 [W45]  
D710 [D28] SD500 [SD20]

### AD-101 LT

Single seat unit with left handed integrated tablet



H820 [H32] SH480 [SH19]  
W1035 [W41]  
D915 [D36] SD500 [SD20]

### AD-101 RT

Single seat unit with right handed integrated tablet

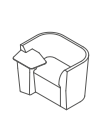

H820 [H32] SH480 [SH19]  
W1035 [W41]  
D915 [D36] SD500 [SD20]

### AD-102 LT

Single seat unit, screen with left handed integrated tablet

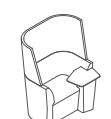

H1470 [H58] SH480 [SH19]  
W1140 [W45]  
D965 [D38] SD500 [SD20]

### AD-102 RT

Single seat unit, screen with right handed integrated tablet

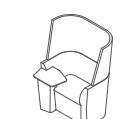

H1470 [H58] SH480 [SH19]  
W1140 [W45]  
D965 [D38] SD500 [SD20]

### AD-103

Three seater unit

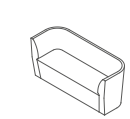

H820 [H32] SH480 [SH19]  
W835 [W33]  
D660 [D26] SD500 [SD20]

### AD-104

Three seater unit & screen

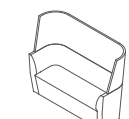

H1470 [H58] SH480 [SH19]  
W1940 [W76]  
D710 [D28] SD500 [SD20]

### AD-103 LT

Three seater unit with left handed integrated tablet

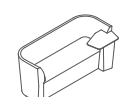

H820 [H32] SH480 [SH19]  
W1835 [W72]  
D915 [D36] SD500 [SD20]

### AD-103 RT

Three seater unit with right handed integrated tablet

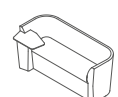

H820 [H32] SH480 [SH19]  
W1835 [W72]  
D915 [D36] SD500 [SD20]

### AD-104 LT

Three seater unit, screen with LH integrated tablet



H1470 [H58] SH480 [SH19]  
W1940 [W76]  
D965 [D38] SD500 [SD20]

### AD-104 RT

Three seater unit, screen with RH integrated tablet

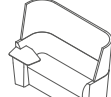

H1470 [H58] SH480 [SH19]  
W1940 [W76]  
D965 [D38] SD500 [SD20]





## Product Specification

### Standard Product Description

**Frame:** FSC® Plywood & FSC® Hardwood frame with glued & screwed units.

**Seat & Back:** Elasticated sprung seat & foam back.

**Foam:** Vitafoam Reflex.

**Glides:** Adjustable & linkable glides with non-marking elastomer foot.

**Edge Details:** Melamine Chamfered Edge. [AD-67 RE & AD-67 SQ]

**Banquette Table Column and Foot:** Finished in RAL 9006, Black or White.

### Table Top Finishes:

Melamine – Walnut, Grained Oak, Artisan Oak, Beech, Graphite, White or Grey.

Laminate – White Fleetwood, Natural Davos, Grey Arizona, Tobacco Charleston or Grey Bardolino.

Laminate Fenix – 2630 Pimobo Doha, 0720 Negro Ingo, 0724 Grigio Bromo, 0718 Grigio Londra, 2638 Titanio Doha, 0725 Grigio Efeso, 0030 Bianco Alaska.

Laminates not available on AD-81 DS, AD-81 OV, AD-81 GR, AD-81 GT, AD-81 HE120, AD-81 HE90, AD-82 DS, AD-82 OV, AD-64 LRO, AD-64 SW, AD-64 LW, AD-64 HE, AD-86 LH, AD-86 RH, AD-91 LRO.

### Optional Upcharges

**Power:** Base or Arm power options available.

**Monitor:** Tilting Monitor Brackets available as an upcharge on Media Den Units.

**Banquette Table Column and Foot:** Black Foot and Chrome Column available as an upcharge. Or Foot and Column finished in Gold, Taupe, Industrial Silver, Bronze or Copper.

### Product Certification

#### Intertek Sustainability Clean Air Product Certification

Clean Air certification provides proof that products have been independently tested and found to conform to VOC standards and to the ANSI/ BIFMA Furniture Emissions Standards. All Orangebox products\* have achieved Gold certification, excluding laminate products which achieve a Silver certification.

\*With the exception of Fielding Tables.

#### BS 16139: 2013

Test Level 1 - Strength & Safety.

## Table Finishes

### Edge Details

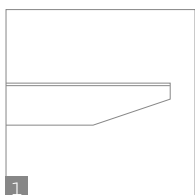

1. Chamfered Edge

## Fabric Selection

### Modular Units

Modular seating units have up to 4 upholstery choices.

These choices are stated in the diagram opposite.

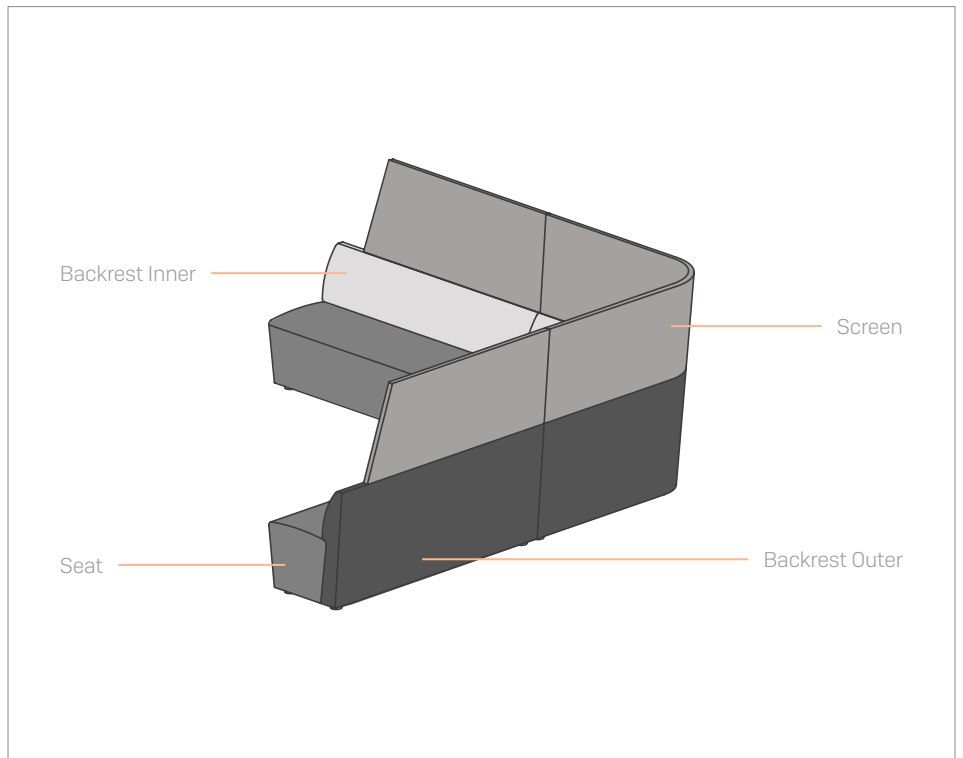

### Detached Seating

As with the modular units above, the main body of the detached seating is split into 5 upholstery choices.

Some stand alone seating units have the addition of an integrated tablet base as a separate upholstery choice.

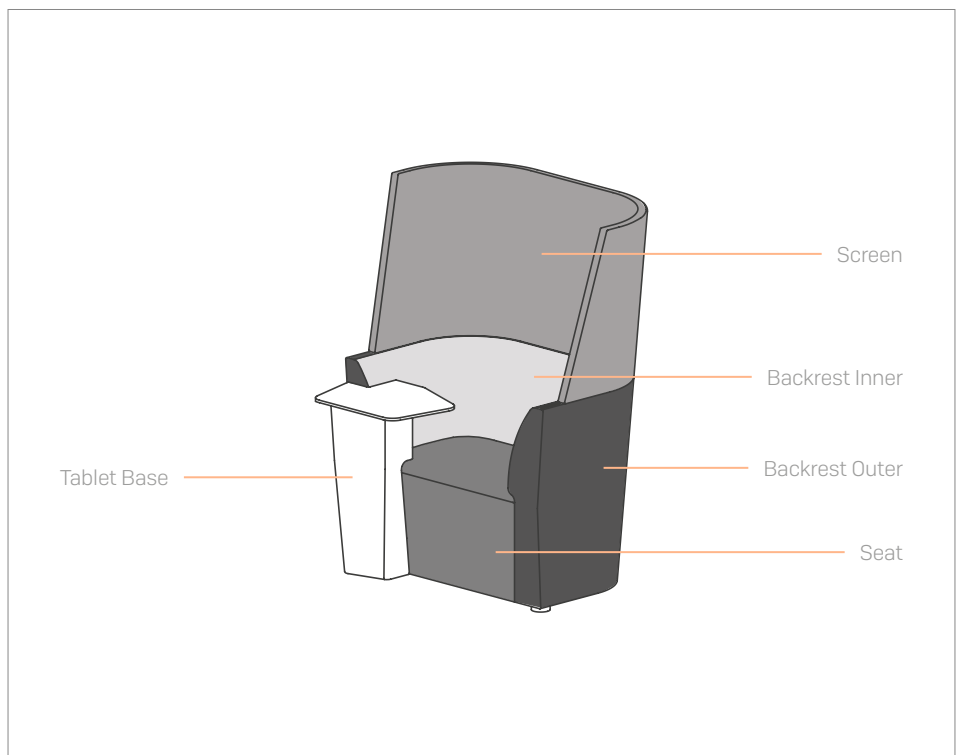

## Fabric Selection

**Striped, patterned or plaid fabrics are only available for specification on the seat or backrest inner portions as illustrated below.**

When selecting fabrics with regular patterns for Away from the Desk, panels will be cut by hand to ensure the pattern matching is as accurate as possible. This is due to the fabrics tendency to wrap as it is upholstered across a curved surface.

### Horizontal Strips

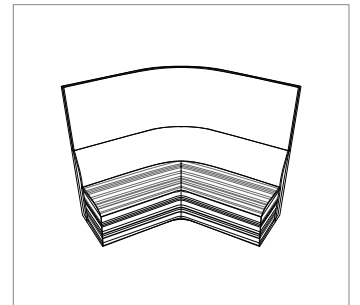
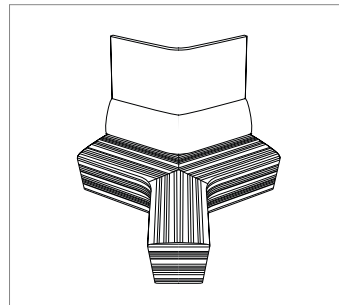
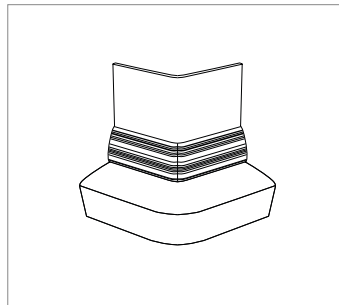
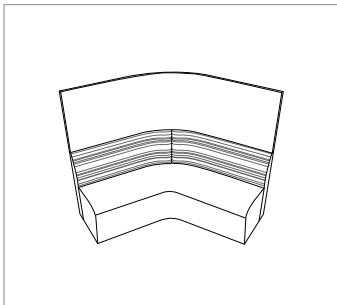

### Horizontal Strips

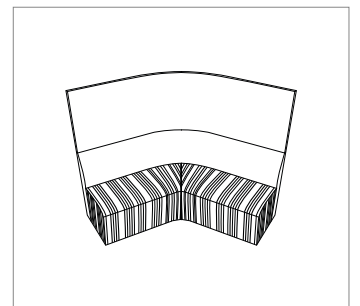
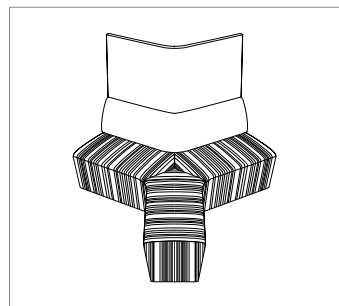
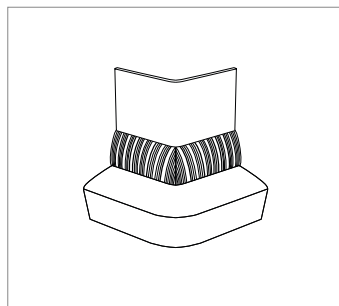
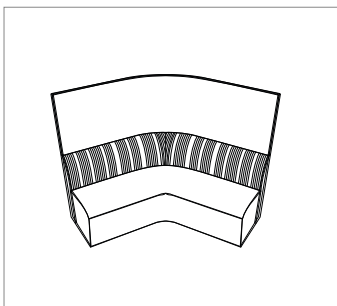



## Product Finishes

### Table Tops — Melamine

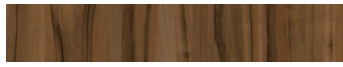

Walnut



Grained Oak



Artisan Oak



Beech



Graphite

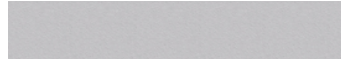

Grey



White

### Table Tops — Laminate



White Fleetwood



Natural Davos



Grey Arizona

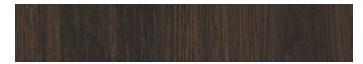

Tobacco Charleston



Grey Bardolino



Fenix 2630 Piombo Doha



Fenix 0720 Nero Ingo



Fenix 0724 Grigio Bromo



Fenix 0718 Grigio Londra



Fenix 2638 Titanio Doha



Fenix 0725 Grigio Efeso



Fenix 0030 Bianco Alaska

### Banquette Table Column & Foot



RAL 9006



Black



White



Chrome



Gold



Taupe



Industrial Silver



Bronze



Copper